

PROPERTY FOR SALE

Location:

Street Address: 1120 Parkman Road

City/State: Warren, OH

County: Trumbull

Property Information:

Lot 1: Property Size: Frontage: 174 feet Depth: 84 feet (Irregular) Acres: 1.104

Building: Yes No

Size of Building: N/A

Zoned: Commercial

Environmental Status: Fully Remediated

Access to:

City Water: Yes No Sewer: Yes No Gas: Yes No Electricity: Yes No

Market Area: The property is located in a mixed commercial and residential area, at the intersection of Parkman Road (422) and Garden Street.

Adjoining Owners/Uses: There mostly residential properties surrounding the site, with a variety of commercial properties also in the vicinity. Some of the commercial properties nearby include Vernon Sales & Rentals, Warren Concrete & Supply, and Eclipse Automotive, along with other local businesses.

ASKING PRICE:

Lot 1 (1.104 Acres): \$75,000

Additional Property Detail: Given the property’s location, visibility, and mixed market area, this site could suit a wide variety of businesses.

PROXIMITY MAP

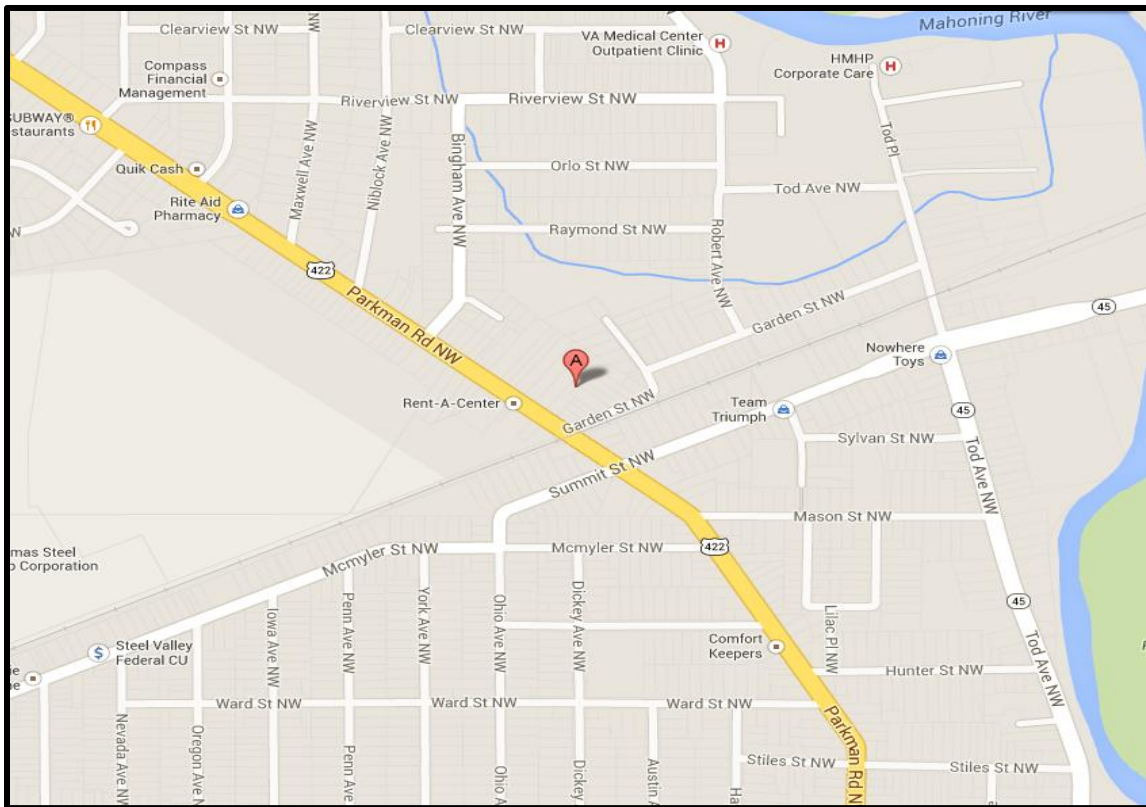

PROPERTY DIAGRAM



Information deemed to be correct – accuracy not warranted

PROPERTY PHOTOS

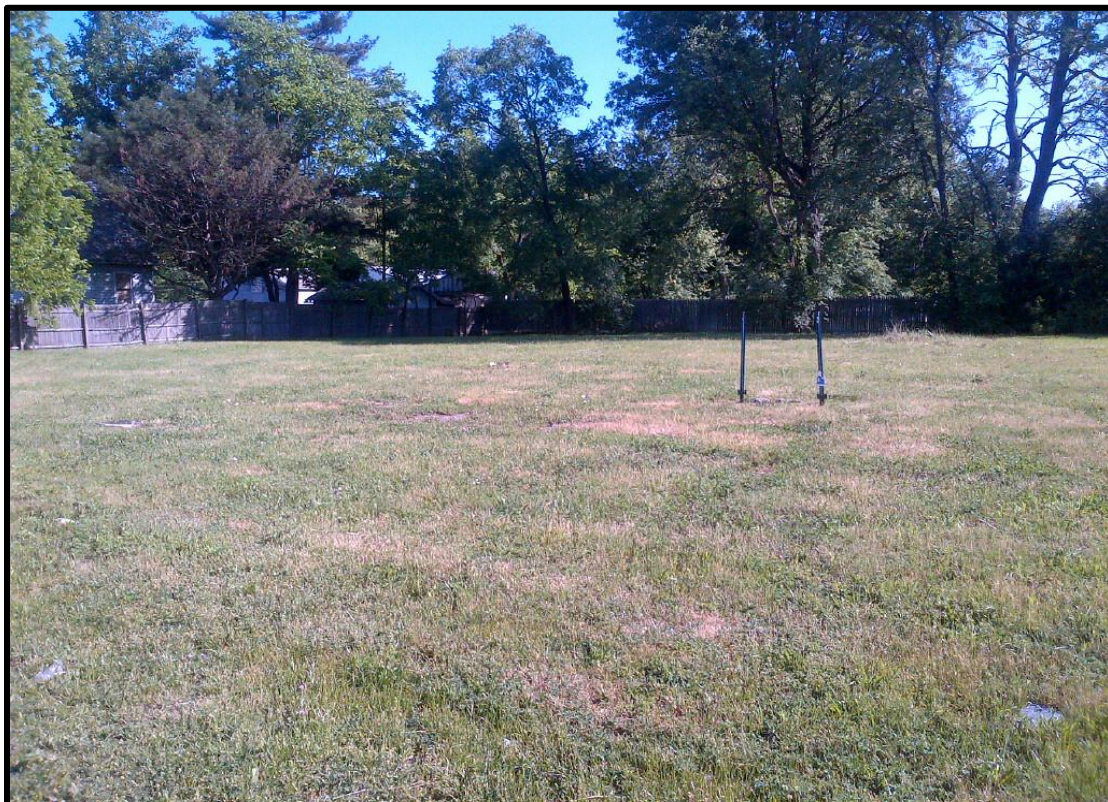

Information deemed to be correct – accuracy not warranted