



Commercial Real Estate

FOR SALE 1.06± ACRES

Asking Price: \$45,000

9402 Kingston Rd. Shreveport, LA 71118

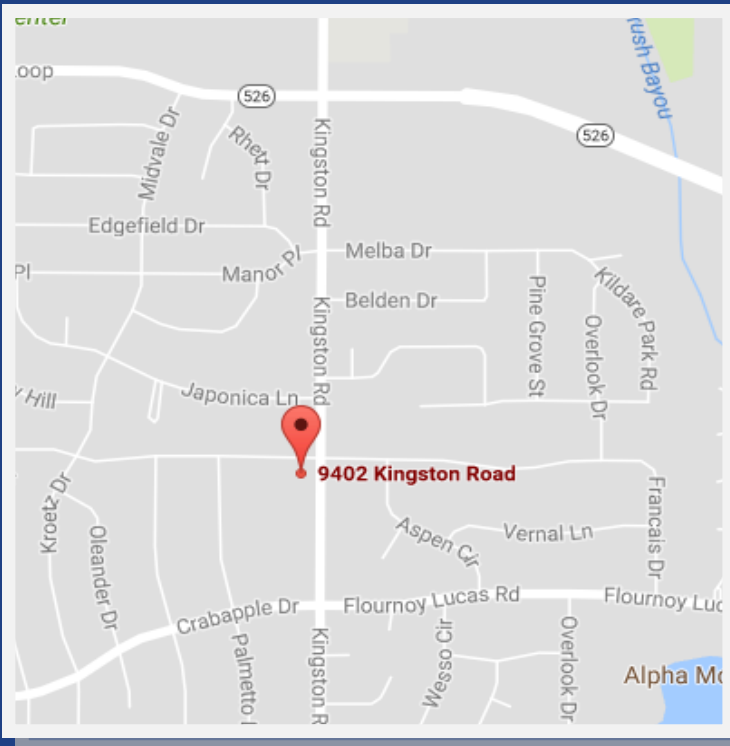

Property Description

This property is located in the middle of a solid residential area with some commercial and light industrial use mixed in. The lot is vacant and ready to use. Given the property’s location, strong residential support, and mixed market area, a wide variety of businesses could be successful here.

MPC Unit 3558



Aerial Photo



Property Information

- Lot Size: Approx. 1.06 Acres
- Frontage: 200 ft. Depth: 230 ft.
- Zoning: Commercial
- City Utilities: Water, Sewer, Gas, Electric



Property Boundaries

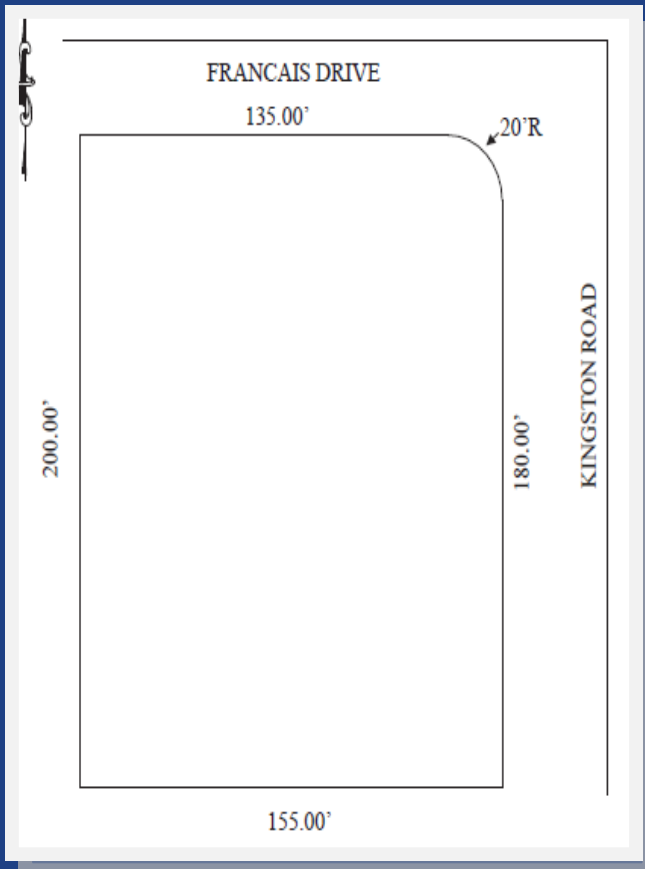

Surrounding Properties

- Residential (Immediate Area)
 - Church (North)
 - Medical Center (South)